

APPROVED: _____
 DATE: _____ TITLE: _____

Rev	AWO #	Description	Date	Appr
-		RELEASED	2/18/21	
A		UPDATE DRAWING	6/21/21	WX/RC

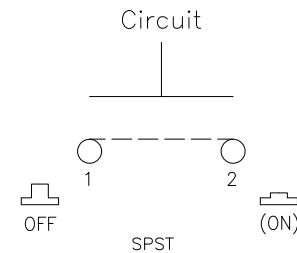
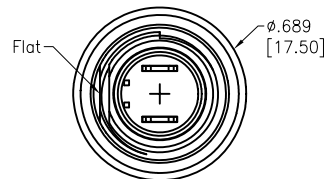
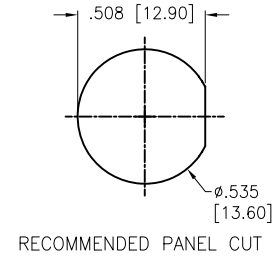
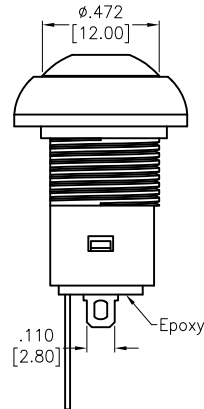
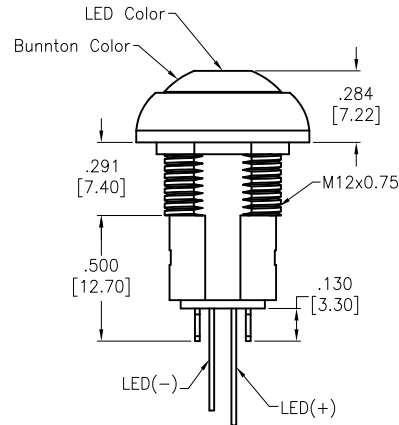

SW-PB11-4CSXX-10

Button Color		LED Color	
R	Red	R	Red
G	Green	G	Green
Y	Yellow	Y	Yellow
O	Orange	B	Blue
B	Blue	W	White
W	White		
K	Black		

SPECIFICATIONS:

Material:
 Case: Polyamide66, rated UL 94V-0
 Bushing&Button: Polyamide66
 Terminal: Gold over Silver Plated
 Electrical:
 Rating: 100mA 24VDC
 2A 125VAC
 Contact resistance: 50 mΩ max
 Insulation resistance: 1G-ohms min @500VDC
 Dielectric withstanding voltage: 1,000 VAC rms
 Mechanical:
 Torque: 0.5Nm max
 Operating Force: 2~5N
 Temperature Rating:
 Operating temperature: -30°C to +85°C
 Environmental:
 IP67 front panel protection
 Lead free, RoHS compliant



UNLESS OTHERWISE SPECIFIED ALL DIMENSIONS ARE INCHES [MM] TOLERANCES: EXCEPT AS NOTED INCHES HOLES .X ± .10 Ø.X ± .10 .XX ± .020 Ø.XX ± .015 .XXX ± .015 Ø.XXX ± .010		ADAM TECH 909 Rahway Avenue, Union, NJ 07083 Phone: 908-687-5000 Fax: 908-687-5710	
TITLE IP67 PUSH BUTTON SWITCH, SOLDER TYPE, LIGHTED, SPST, OFF-ON, GOLD OVER SILVER PLATED			
APPROVALS DRAWN LH 2/18/21 CHECKED AC 2/18/21 APPROVED		DATE 2/18/21 2/18/21	
SIZE X	PART NO. SW-PB11-4CSXX-10	REV. A	REF: S00198T
SCALE: NTS		SHEET 1 OF 1	